



Biopro External Canister Filter

800 | 1200 | 1800 | 2200 Models



CONTENTS PAGE

Important Safeguards 1

Before First Use/ Preparation 2

Know Your Filter 3

Recommended Filter Set Up 4

Set Up Instructions 6

Starting Your Filter 6

Maintenance 7

Troubleshooting 8

Specifications 10

IMPORTANT SAFEGUARDS

To protect against injury, basic safety precautions should be observed including the following;

1. Read and follow all safety instructions and important notices outlined in these instructions as well as on the product itself.
2. This appliance is not intended for use by children

or infirm persons without supervision. Young Children should be supervised to ensure they do not play with the appliance.

3. To avoid possible electric shocks, special care should be taken since water is incorporated in the use of aquarium equipment. For each of the following situations do not attempt repairs yourself. Return the appliance to an authorised service facility for service or discard the appliance.
 - a. If the appliance or any electrical component of the appliance (nonsubmersible equipment only) falls into the water or gets wet, do not reach for it, Unplug the appliance then retrieve it.
 - b. If the appliance shows any sign of abnormal water leakage, immediately unplug it from the power source.
 - c. Carefully examine the appliance after installation. It should not be plugged in if there is water on parts which are not intended to be wet.
 - d. Do not operate the appliance if it has a damaged cord or plug, or if it is malfunctioning or dropped or damaged in any manner.
4. A 'drip loop' (see Graphic) should be arranged for each cable connecting an aquarium to a power supply. The drip loop is the part of the cable below the level of the power supply. It prevents water travelling down the cable and coming into contact with the power supply. If the plug or socket does

get wet, do not unplug the appliance. Disconnect the fuse or circuit breaker that supplies the power to the appliance, then unplug and examine for presence of water in the socket.

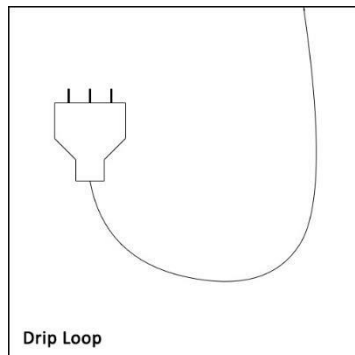

5. Always unplug the appliance from the electrical outlet when not in use, before putting on or taking parts, before any type of maintenance or cleaning.
6. Never yank on the cord when unplugging the appliance from the socket. Gently pull the plug carefully to disconnect.
7. Do not use the appliance for reasons other than intended use. The use of attachments that are not recommended or sold by the manufacturer may cause the product to be unsafe or not work properly.
8. Do not install or store the appliance in an exposed environment such as direct sunlight or temperatures below freezing.
9. Make sure any components mounted on an aquarium is securely installed before operating.
10. Ensure input voltage is the same as your local power supply
11. If an extension cord is used it should have the proper safety ratings. Care should be taken to arrange the cord, so it will not be accidentally pulled or become a trip hazard.

-
12. A G.F.C.I (Ground fault circuit interrupter) & surge protector is recommended for all electrical appliances
 13. Ensure your hands are dry when turning the power switch on/off and when inserting/removing the power cable from the socket
 14. If you are in any doubt about the electrical installation or safety of this product you must consult a qualified electrician before operating.

Before First Use / Preparation

Read and follow all the instructions, even if you feel you are familiar with the product and find a place to keep the instructions handy for future reference. Your attention is drawn particularly to the sections concerning **Important Safeguards** and the **“Guarantee Conditions”**. Please ensure you retain all your original purchase receipts and/or invoices if a guarantee service is required.

Carefully unpack the filter making sure to keep all the packing material until all the parts of the product have been found and the product has been fully assembled.

This filter is shipped to you in a factory sealed carton. Should the product malfunction in any way or if the unit is damaged and requires replacement, contact the retailer where the product was purchased for inspection.

Know Your Filter

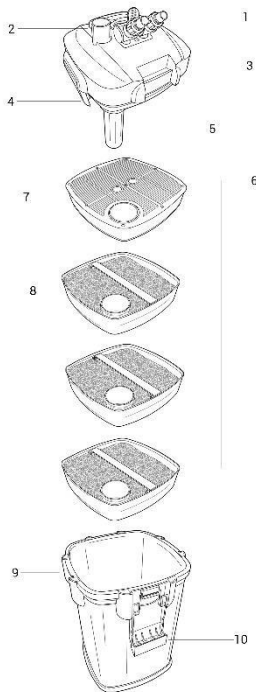

Find all spare parts at www.aquaholicsonline.com.au



Parts

- 1. Inlet/Outlet taps
- 2. Primer
- 3. Filter Head/Motor
- 4. Head Clips
- 5. UV Steriliser (UV Models Only)
- 6. Baskets
- 7. Basket Cover
- 8. Filter Media
- 9. Canister Body
- 10. Body Clips

Recommended Filter Set Up

EF800

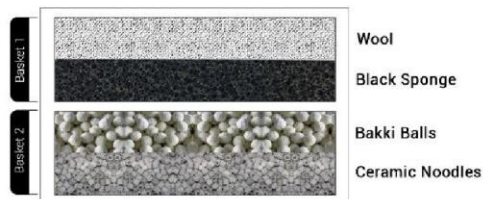

EF1200/UVF1200

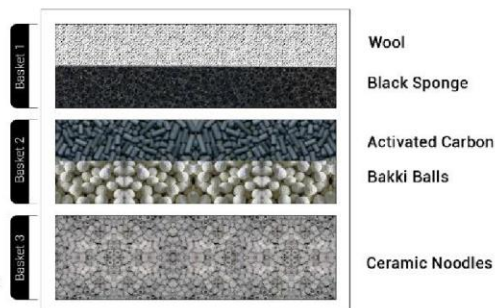

UVF1800



UVF2200

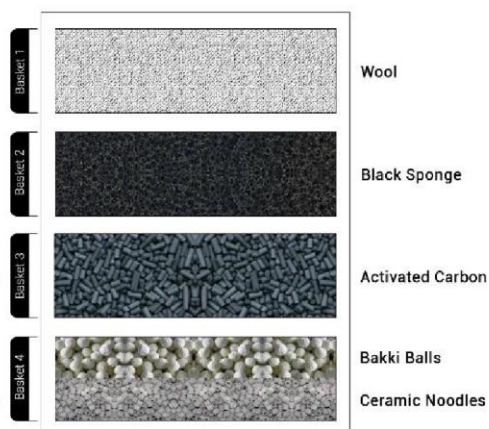

Set Up Instructions

Filling and Unpacking Media

1. Open the filter by releasing the clips, begin with the larger clips then proceed with releasing the smaller clips. Once all four clips have been released gently lift the head off the body.
2. Remove the Basket cover and all baskets from the canister, remove all media from the plastic packaging and put back into the baskets according to the diagrams shown on page 3. Gently rinse the baskets and media with tap water to remove any excess dust.
3. Ensure that the baskets are sitting flush on top of each other with the basket cover and basket O-ring installed on the top basket.

Checking the Function

4. Prior to installing the head unit, connect it to a power source. You should be able to feel and hear the impeller spinning. If there are any problems refer to the Troubleshooting section found on page 9. Disconnect from the power source after a few seconds to avoid any damage to the powerhead or impeller.

Installing the UV Bulb (UV Models Only)

5. To install the UV bulb turn the head upside-down so that the black sleeve is facing upwards. Turn the black sleeve anti-clockwise and pull away from the head to reveal the quartz sleeve. To remove the quartz sleeve gently twist anti-clockwise and pull away from the head which will now give you access to the bulb housing.
6. Hold the bulb, making sure not to touch the glass with your bare skin and push the bulb into the housing until you hear a click.

7. Install the quartz sleeve back into the head by gently pushing it into the fitting and turning clockwise until the sleeve will no longer turn. Do the same for the black sleeve.
8. Line the filter inlet with the feeder pipe (or UV sleeve on UV models) on the base of the head unit.
9. Press down gently and evenly on the head unit until you hear the small clips click. Once the small clips have been locked proceed with engaging the large clips by slotting the clips into the grooves on the head and pushing inward until you hear the clips click. The filter should now be ready to install.

Installing Tap Connectors and Hose Pipes

10. You will need the Tap set and both pieces of hose. Push the hose as far up the nozzle as possible. Turn the nozzle collar anti-clockwise to lock the hose in. Repeat this step with the other nozzle and hose.
11. Attach the taps to the top of the filter head and push the red locking lever down until it is flush with the head.
12. Place the canister in the desired position and feed the hose through the cabinet or stand.

Assembling the Inlet and Outlet Pipes

10. To assemble the outlet, you will require the pieces shown below.

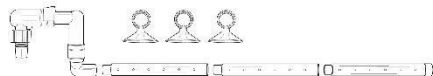

11. The U pipe (a) should come with the outlet elbow attached (b) Insert the correct number of spray bar sections (c) into the elbow making sure to attach the end section (d) with the cap last.

12. Attach the suction cups, ensure that they are spread out evenly on the length of the spray bar.
13. To assemble the inlet, you will require the pieces shown below.

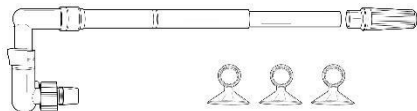

14. The U Pipe (a) should come with the extension pipe (e) already attached. Attach the suction cups to the extension pipe, ensure that they are spaced out evenly on the length of the pipe. Simply attach the strainer (f) to the end of the extension pipe
15. Install the inlet first. (One with the strainer) Place it into the aquarium so the strainer is fully submerged. Using the suction cups stick it to the glass wall.
16. Connect the hose attached to the inlet tap nozzle to the inlet U pipe. Turn the inlet pipe collar anti-clockwise until hand tight to lock the hose in.
17. Repeat steps for the outlet pipe. Using the suction cups attach the spray bar to the back or side of the aquarium. You are now ready to start the filter!

Starting Your Filter

Note: Your aquarium must be filled with water to prime your filter. Ensure the tap is in the ON position by pressing the adjustment lever all the way down. Once the filter is running double check the fittings and seals for water tightness.

Method

1. Temporarily detach the outlet hose from the outlet pipe and create a siphon by sucking on the tube. Once the siphon is successful lower the hose into a bucket.
2. Wait until the canister is completely full of water. You will know when the canister is full when water starts to come out the outlet hose.
3. Cover the end of the hose with your finger then attach the hose back to the outlet pipe
4. Your filter should now be fully primed, so you can now connect it to a power source.

Maintenance

1. Turn the canister off at the socket and unplug
2. Lift the flow adjuster on the tap to close of the flow.
3. Place a towel or a shallow container underneath the canister, this will prevent any water spillage on your cabinet or floor which can cause damage or become a slipping hazard.
4. Lift the red tap lever to disengage the taps from the head of the unit, making sure that the flow adjuster is in the closed position.
5. Fill a bucket or container with water from your aquarium and take it to where you intend on cleaning your filter. Keep in mind that cleaning your filter can be messy work, we recommend cleaning outside or at a sink. Ensure that there are no soaps, detergents chlorines etc. that may kill good bacteria and interfere with your waters balances.
6. Open the canister by first releasing the large clips then smaller clips. You should be able to easily remove the head from body by gently lifting the head. Place the head upright in a safe spot.
7. Remove the filter grid and carefully remove the baskets using the inbuilt handles.
8. Remove the filter sponges and fine wool from the baskets and dunk the baskets into the buckets of aquarium water several times. This will clear some of the dirt that can build up on the baskets which clog up the system and prevent good filtration.
9. Either replace or rinse the fine wool, the fine wool will deteriorate over time so once you can no longer properly clean it you will need to replace it.
10. The filter sponge should only require a quick rinse in the bucket, make sure to ring the

sponge out to get rid of any dirt or debris that can clog up the system.

11. Place the sponges and fine wool back into their designated baskets, reinsert the media

back into the now clean baskets ensuring that enough room is left so the baskets can be sat on top of each other.
12. The Impeller and impeller housing should also be inspected and cleaned while the head is not attached to the canister body.
13. To Remove the impeller, turn the impeller cover anticlockwise.
14. Clean the impeller housing using a small cloth or toothbrush like tool to get rid of any excess gunk or debris that can reduce the impellers efficiency.
While the impeller is out of its housing it is a good time to inspect and check to see if there is any damage to the impeller which can decrease its effectiveness
15. Detach the impeller from the impeller cover.
16. Pull the rubber cap off the end of the impellers ceramic shaft and carefully slide the shaft out of the impeller. Run water through the hole in the impeller, then rinse the impeller and shaft to remove any gunk or debris.
17. Put the impeller back together and ensure that it rotates freely on the shaft then reassemble the head unit. Apply aquarium friendly lubricant to the O-ring on the head, this will provide a better seal and make removal of the head easier during the next maintenance.
18. Check your inlet and outlet pipes and hoses for any excess gunk or grime that has built up. To clean these remove them from your

aquarium and run hot water through them to loosen up any gunk that may be present. Run a pipe brush through them and flush them through again with hot water.

19. Return the canister to the cabinet or stand and reattach the taps.

Troubleshooting

The filter unit is leaking

1. Check that all O-rings are in place and are not damaged
2. Re-apply aquarium friendly lubricant to Orings
3. Check that all media buckets are aligned properly
4. Ensure the taps are inserted and installed correctly in the locked position

The filter will not prime

1. Check the tubing for kinks
2. Ensure the taps are inserted and installed correctly in the locked position
3. Check that the aquarium is filled with water
4. Make sure the intake pipe and/or intake strainer are not blocked.
5. Ensure that each hose is connected to the unit correct. Inlet to IN and outlet to OUT.

The filter will not start

1. As previous tips
2. Check the impeller and shaft are in good condition
3. Verify that the filter is plugged in with the power turned on. **Poor water flow**

1. As both previous tips
2. Clean filter media
3. Clean both inlet and outlet pipes and hoses **Both water and air coming from the outlet pipe**

1. Leave for 4-5 minutes
2. Make sure no air stones are operating near the intake strainer

20. Refer to the "Starting Your Filter" section for details on restarting the unit.

-
3. Check all tubing is connected and locked in firmly
 4. Check all O-rings and re-apply aquarium friendly lubricant
 5. Gently rock the canister side to side and back and forth to dispel any air bubbles caught in the impeller housing.

The filter is making noise

1. As all previous tips.
2. Outlet or inlet flow is restricted. Check tubing.

Specifications

Canister Model Code: EF800
Media Baskets: 2
Max Aquarium Volume: 200L

Maximum Flow Rate:
800LPH
Power Requirements: 220-240V
Power Consumption: 15W
Suitable: Tropical, Marine, Cold water

Canister Model Code: EF1200
Media Baskets: 3
Max Aquarium Volume: 300L

Maximum Flow Rate:
1200LPH
Power Requirements: 220-240V
Power Consumption: 25W
Suitable: Tropical, Marine, Cold water

Canister Model Code: UVF1200
Media Baskets: 3
Max Aquarium Volume: 300L

Maximum Flow Rate: 1200LPH
Power Requirements: 220-240V
Power Consumption: 25W
UV Lamp: 7W
Suitable: Tropical, Marine, Cold water

Canister Model Code: UVF1800
Media Baskets: 3
Max Aquarium Volume: 450L

Maximum Flow Rate:
1800LPH
Power Requirements: 220-240V
Power Consumption: 35W
UV Lamp: 9W
Suitable: Tropical, Marine, Cold water

Canister Model Code: UVF2200
Media Baskets: 4
Max Aquarium Volume: 550L

Maximum Flow Rate: 2200LPH
Power Requirements: 220-240V
Power Consumption: 45W
UV Lamp: 9W
Suitable: Tropical, Marine, Cold water